

Detalle de Juntas de Aberturas Metàlicas

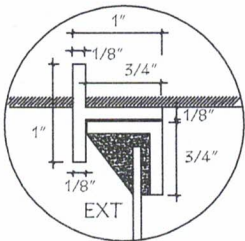

A-A

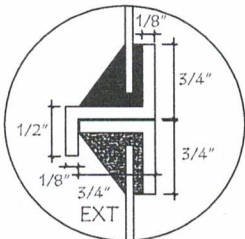

B-B

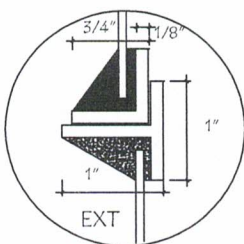

C-C

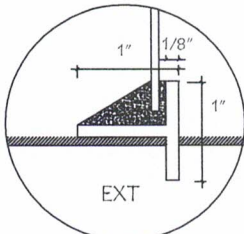

D-D

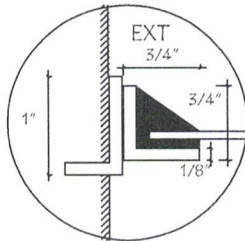

H-H

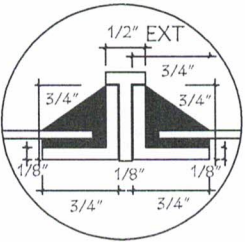

I-I

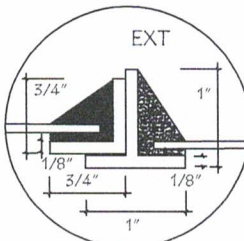

J-J

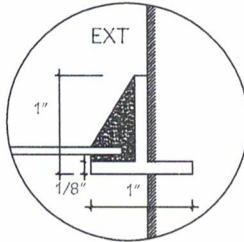

K-K

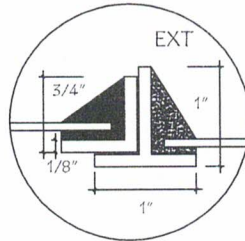

N-N

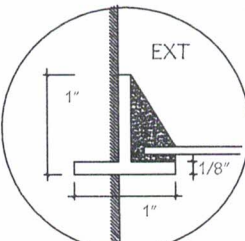

Ñ-Ñ

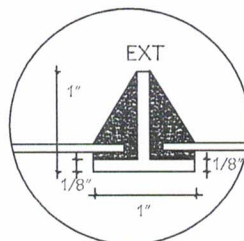

O-O

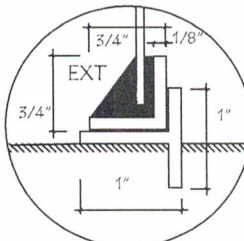

P-P

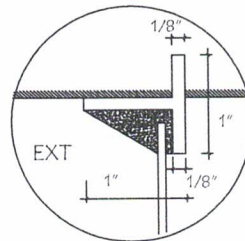

E-E

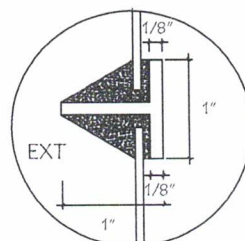

F-F

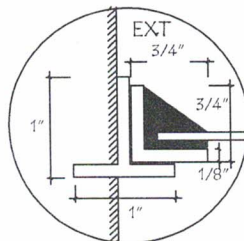

L-L

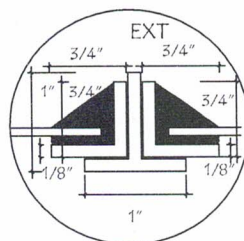

M-M

MINISTERIO DE EDUCACION Y CIENCIAS		
DIRECCION DE INFRAESTRUCTURA		
PROYECTO	Cocina - Comedor de 8,60 x 10,90 con techo de tejas	5
Detalle de Juntas de balancín		
		sin escala

Desiderio López Álvarez
Ingeniero Civil
C.I.P./R.P.I. N° 1.026.553



Aldo Sixto Armoa Fleitas
Intendente Municipal